

CANYON - PE embrice for road and railway embankments

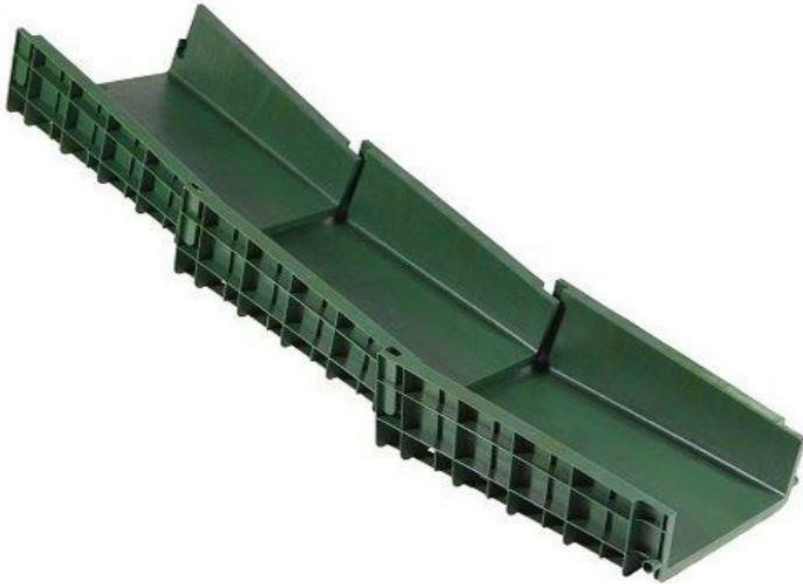

Description

Embrice in polyethylene (PE) for conveying liquids on steeply sloping surfaces, such as road embankments, railways or waste dumps, entirely green in colour, equipped with reinforcing slats on the external surfaces which are also useful for improving fixing in the laying ground, with double pin cylinder connection which allows altimetric variation $\pm 20^\circ$ and absorption of thermal expansion, with predisposition for fixing to the ground by driving an awl or using a steel cable.

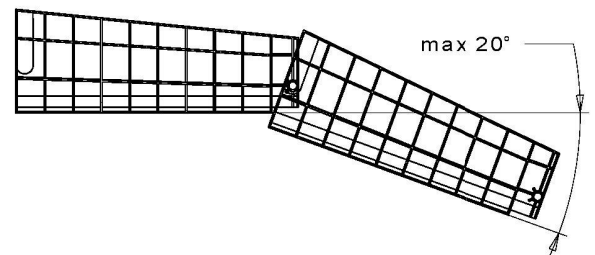
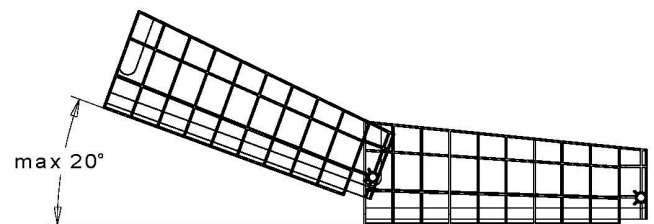
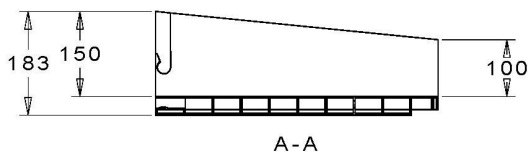
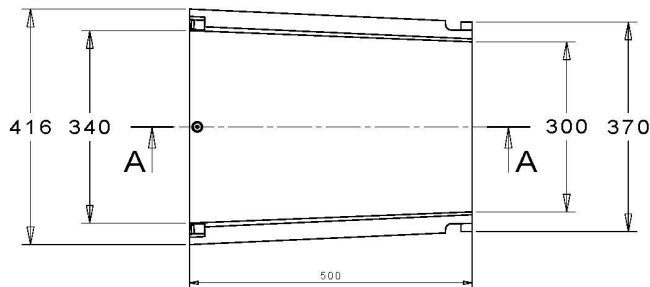

The Company reserves the right to change the dimensional characteristics listed in the table without prior notice while maintaining the performance indicated.

